



OSE



























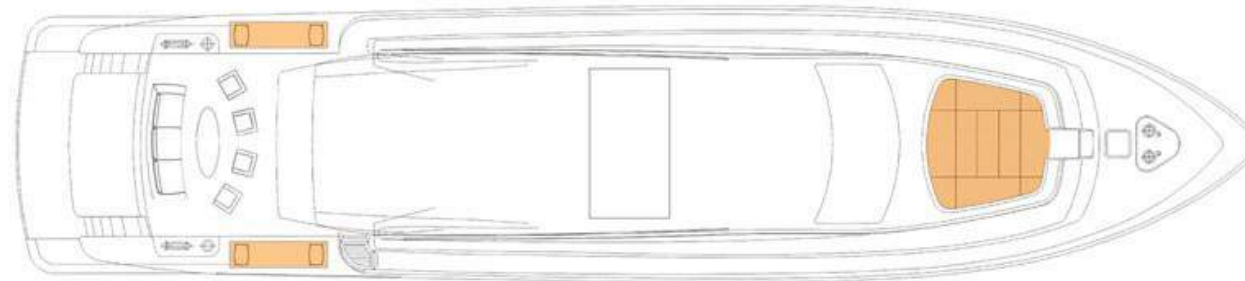
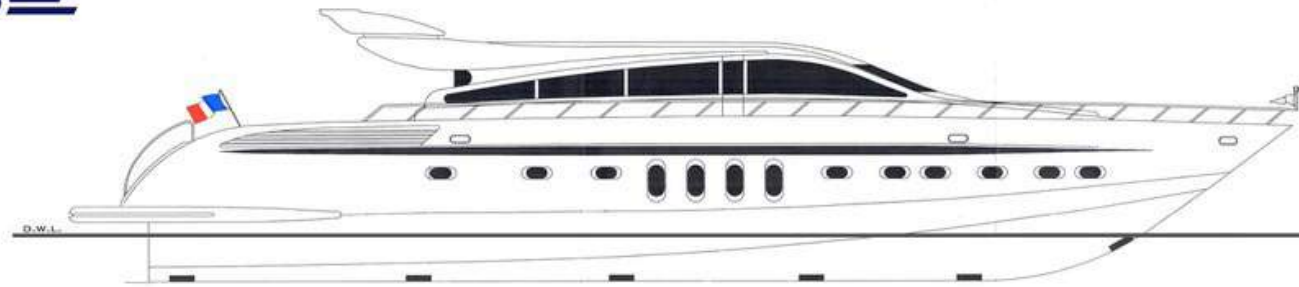



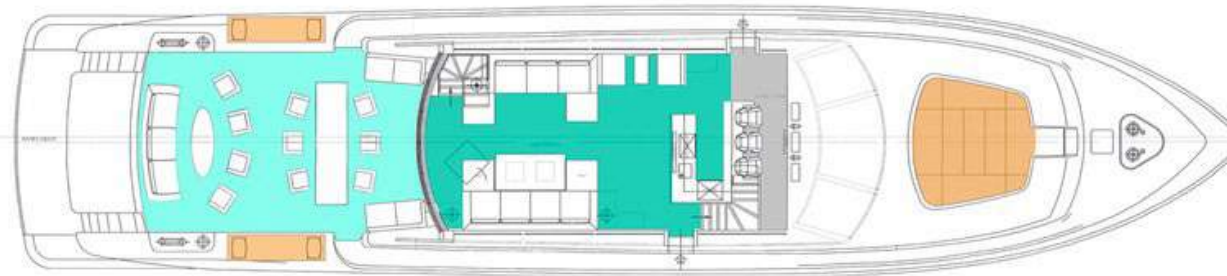



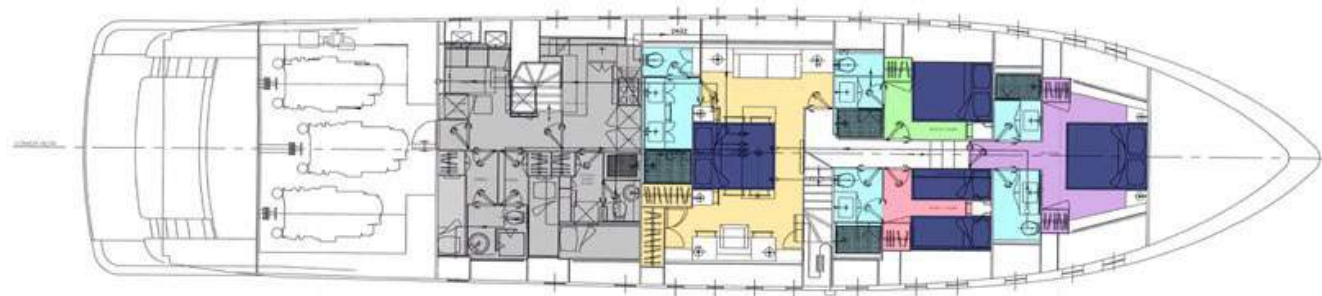

 Sunbath area



 Sunbath area  Outside saloon  Inside saloon  Wheelhouse



 Crew area  Bathroom  Master cabin  Twin cabin with extra pullman  Guest cabin (double bed)  VIP cabin  Bed



SPECIFICATIONS

Length (m/ft):	31.00m (101' 8")
Beam (m/ft):	7.00m (23')
Draft (m/ft):	1.80m (5' 11")
Year Built:	2011
WiFi:	Yes
Air conditioning:	Yes
Number of Cabins:	4
Maximum guests sleeping:	9
Total guests cruising:	12
Cabin Configuration:	4 Double
Bed Configuration:	1 Pullman, 1 King, 1 Queen, 2 Double
Total crew:	4

TENDERS AND TOYS

Brand new tender (2019) 6 pax

Towable Buoy

Two wake boards

Two Sea bobs F5S

Snorkeling equipment for all sizes and ages

Two paddle boards

One pair of basic water skiing equipment for kids

One fly board (Jet Ski rental needed)

M/Y OSE